

FRONT

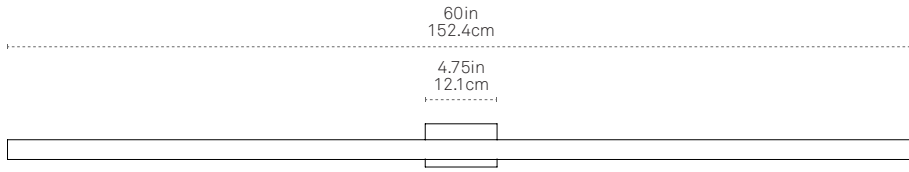

JUNCTION-BOX MOUNTED
- Requires back plate -

SIDE

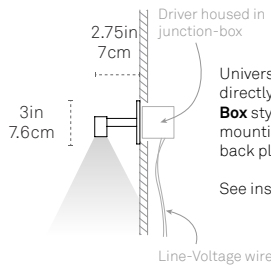

□ Bulb Profile
0.81in x 1.3in
2.1cm x 3.3cm

Universal bracket mounts directly to a 2" x 4" **Switch Box** style junction-box. This mounting option requires a back plate.

See installation options page.

FRONT



DIRECT-WALL MOUNTED
- Remote driver ONLY -

SIDE

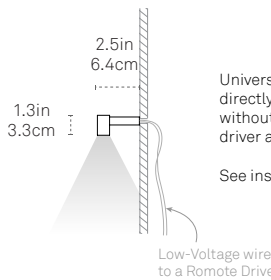

Universal bracket mounts directly to a wall with or without back plate in remote driver applications only.

See installation options page.

SPECIFY PRODUCT OPTIONS:

MODEL

RAY-SCNC-5FT-DIR

WOOD

--	--

METAL

--	--

COLOR TEMP

--	--	--	--

DRIVER

--	--	--

OUTPUT

--	--	--

DESIGN

© 2019

MATERIALS

LED, Sustainably Sourced or Reclaimed Wood, Steel

FEATURES

ADA Compliant
Fully Dimmable
Flexible mounting orientation

CERTIFICATIONS



ORIGIN OF MANUFACTURE

New York City, USA

FIXTURE WEIGHT

6 lbs / 2.7 kg

SHIPPING DIMENSIONS

Ships flat-packed in a corrugated cardboard box. Dimensions and weight TBD based on order quantity.

LIGHT SPECIFICATION

Standard Brightness LEDs :
360 Lumens / 94 CRI (3000K) / 12W Power draw

WOOD*

Maple

M A

American Walnut

W A

Ebonized Oak

E O

Heart Pine (Reclaimed)**

H P

Water Tower Redwood (Reclaimed)**

W T

* Custom wood options available upon approval.

** Our reclaimed woods exhibit variations in tone and grain.

METAL*

STANDARD FINISH

White

W H

Slate Grey

S G

Matte Black

M B

PREMIUM I FINISH

Blackened

B L

Brushed Nickel

B N

Brushed Brass

B B

PREMIUM II FINISH

Polished Nickel

P N

Polished Brass

P B

* Custom options available upon approval.

COLOR TEMP

2400K

2 4 0 0

2700K

2 7 0 0

3000K (Standard)

3 0 0 0

4000K

4 0 0 0

DRIVER & DIMMING OPTIONS*

120V-277V (Universal dimming including 0-10V)

U N I

Remote Driver**

R E M

* See dimming compatibility.

** Direct-wall mounted option requires remote driver option. See remote driver specifications page. REM option includes driver and remote enclosure box.

LIGHT OUTPUT

Standard Brightness - 12V (Dimmable)

S B

LIGHT DIRECTION

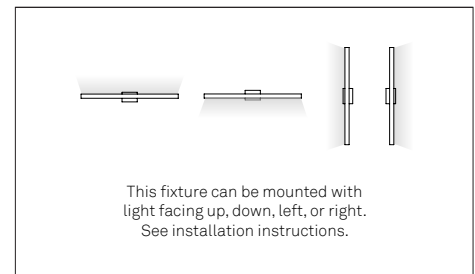

UNI J-BOX MOUNTING FOR 2"x4" SWITCHBOX – BACK PLATE REQUIRED

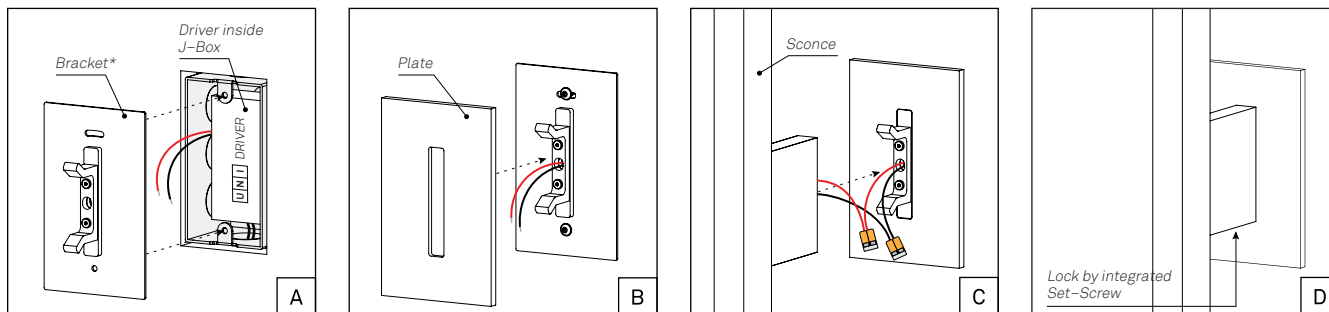

UNI J-BOX MOUNTING FOR 4"x4" JUNCTION BOX – BACK PLATE REQUIRED

+ 2"x4" Switchbox Adapter (sold separately) must be installed before proceeding with steps A - D above

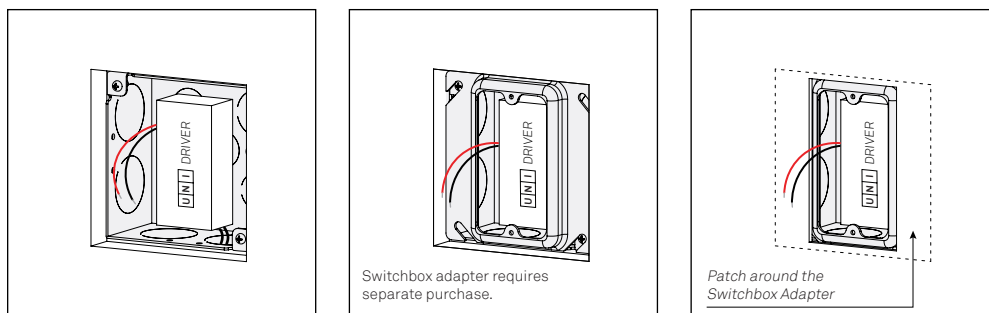

REM DIRECT-WALL MOUNTING – NO BACK PLATE

+ Remote driver application only
+ Cleat mounts directly to wall
+ Guideline Template provided
+ Wire hole: Drill max $\varnothing 1/4"$ to ensure hole is covered by cleat

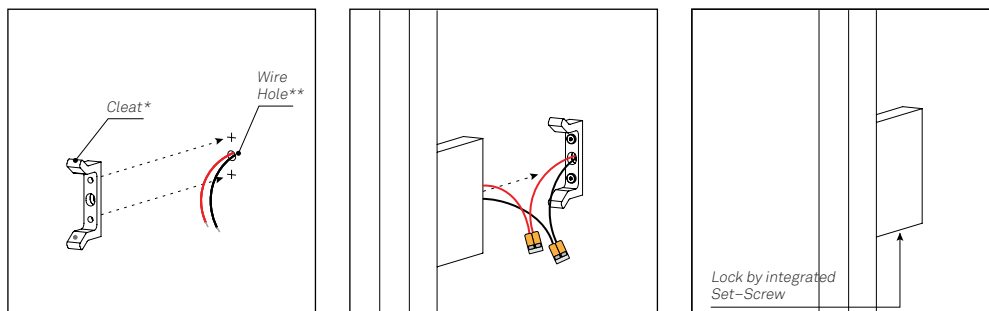

REM DIRECT-WALL MOUNTING – WITH BACK PLATE

+ Remote driver application only
+ Bracket mounts directly to wall
+ Guideline Template provided

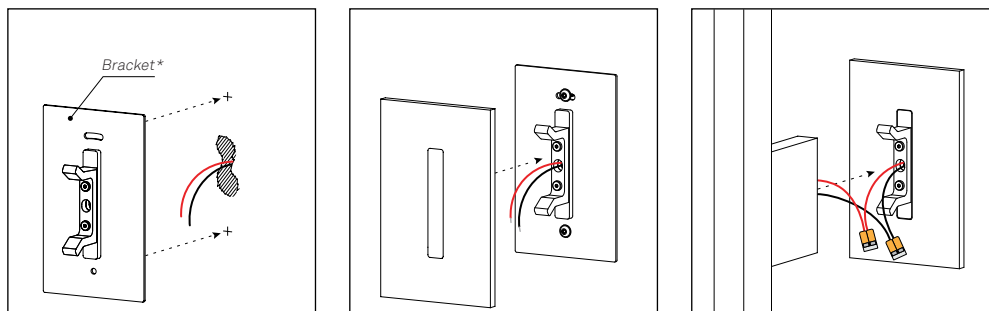

CHOOSING WIRE GAUGE

Use the information below to determine the appropriate wire gauge to lead the driver to the sconces.

WIRE GAUGE	MAXIMUM LEAD LENGTH (10-20V)
24 AWG (0.2 mm ²)	2.5ft (0.8m)
22 AWG (0.34 mm ²)	4ft (1.2m)
20 AWG (0.5 mm ²)	6ft (1.8m)
18 AWG (0.75 mm ²)	10ft (3m)
16 AWG (1.5 mm ²)	15ft (4.5m)
14 AWG (2.5 mm ²)	25ft (7.5m)
12 AWG (4 mm ²)	40ft (12m)

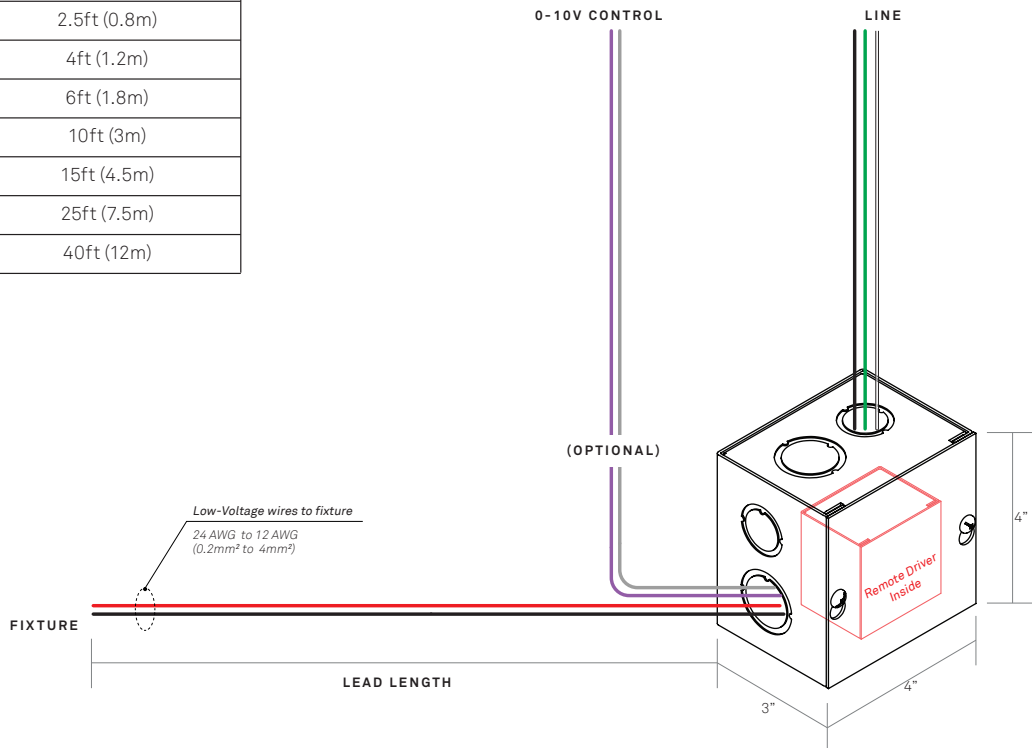

MOUNTING DRIVER ENCLOSURE

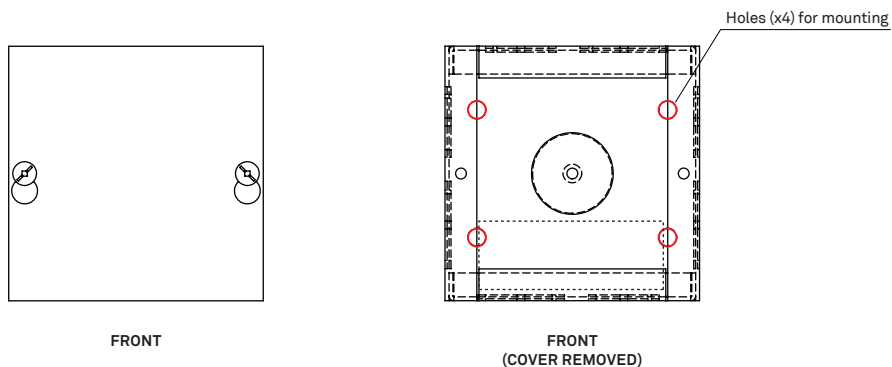



120V-277V driver (Universal dimming including 0-10V)

Manufacture’s specifications (18” and 2’ Ray Sconce):

stickbulb.com/drivers/UNI6

Manufacture’s specifications (3’ Ray Sconce):

stickbulb.com/drivers/UNI8

Manufacture’s specifications (4’ and 5’ Ray Sconce):

stickbulb.com/drivers/UNI12

Low-Voltage Compatible Dimmer brands: Crestron, Lutron, Leviton

For assistance selecting controls, contact LTF at +1 (847) 498-5832 or LTFsales@LTFtechnology.com

Brand	Part number
Crestron	CLS-C6
Crestron	CLS-C6M
Crestron	CLS-C6EX
Crestron	CLS-C6MEX
Crestron	CLS-EXP-DIM
Crestron	CLS-EXP-DIMU
Crestron	CLX-2DIM8
Crestron	DIN-1DIM4
Crestron	DIN-1DIMU4
Crestron	CLW-DIMEX-E
Crestron	CLW-DIMEX-P
Crestron	CLW-DIMSWEX-E
Crestron	CLW-DIMSWEX-P
Crestron	GLX-DIM6
Crestron	GLXX-2DIM8
Crestron	P-DIMEX
Crestron	CLW-DELVEX-E
Crestron	CLW-DELVEX-P

Brand	Part number
Lutron	DVCL-153P
Lutron	DVELV-303P
Lutron	HQRD-6A
Lutron	HQRD-6NA-
Lutron	NTELV-300-
Lutron	NTELV-600-
Lutron	NVELV-600-
Lutron	VTELV-600M
Lutron	MAELV-600-
Lutron	MSCELV-600M
Lutron	MIRELV-600-
Lutron	MRF2-6ELV-120-
Lutron	SELV-300P
Lutron	CTELV-303P
Lutron	SELV-600-

Brand	Part number
Leviton	Model 6615
Leviton	Model 6672
Leviton	Model 6674
Leviton	Model IPL06
Leviton	Model IPE04
Leviton	Model IPI06
Leviton	Model VP106
Leviton	Model VPE04
Leviton	Model VPM06
Leviton	Model VRE04
Leviton	Model VRM10

All of our wood and metal products should be dusted by hand with a dry Swiffer pad (or equivalent) on a regular schedule to maintain surface integrity. It is imperative that none of our products come into contact with bleach, vinegar, lemon juice or any household product which may contain these or other solvents.

If any part of one of our fixtures becomes soiled with dried residue or grime, wipe the affected area with a soft cloth dampened very lightly with warm water and immediately wipe dry with another soft cloth. If this does not complete the task, wipe with a cloth soaked in diluted mild liquid dish soap and again immediately dry.

Fingerprints on our Nickel-plated, Brass-plated, and Blackened metal hardware can be removed with a clean, dry, soft cloth. We recommend an ultra-fine, textureless microfiber cleaning cloth (as one uses to clean glass).

All of our Brass hardware is treated with a protective coating to prevent tarnish. It should need no more than a wipe with a clean, dry, soft cloth to remove fingerprints and dust.

Brushed metal surfaces should be buffed in the direction of the grain.

For scratches in wood we highly recommend Claphams beeswax, which is non-toxic and can be applied by hand. Rub a small amount into the scratch area and buff with a dry cloth.