

## FRONT

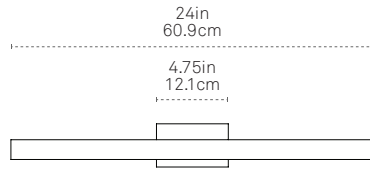

**JUNCTION-BOX MOUNTED**  
- Requires back plate -

## SIDE

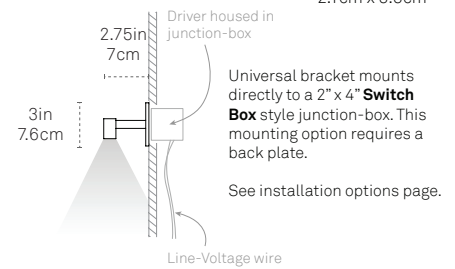

□ Bulb Profile  
0.81in x 1.3in  
2.1cm x 3.3cm

## FRONT



**DIRECT-WALL MOUNTED**  
- Remote driver ONLY -

## SIDE

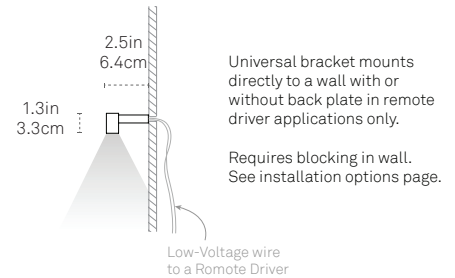

## SPECIFY PRODUCT OPTIONS:

### MODEL

RAY-SCNC-2FT-DIR

### WOOD

--	--

### METAL

--	--

### COLOR TEMP

--	--	--	--

### DRIVER

--	--	--

### OUTPUT

--	--

### DESIGN

© 2019

### MATERIALS

LED, Sustainably Sourced or Reclaimed Wood, Steel

### FEATURES

ADA Compliant  
Fully Dimmable  
Flexible mounting orientation

### CERTIFICATIONS



### ORIGIN OF MANUFACTURE

New York City, USA

### FIXTURE WEIGHT

3 lbs / 1.4 kg

### SHIPPING DIMENSIONS

Ships flat-packed in a corrugated cardboard box. Dimensions and weight TBD based on order quantity.

### LIGHT SPECIFICATION

Standard Brightness LEDs :  
142 Lumens / 94 CRI (3000K) /  
5W Power draw

### WOOD\*

Maple	<b>M</b> <b>A</b>
American Walnut	<b>W</b> <b>A</b>
Ebonized Oak	<b>E</b> <b>O</b>
Heart Pine (Reclaimed)**	<b>H</b> <b>P</b>
Water Tower Redwood (Reclaimed)**	<b>W</b> <b>T</b>

\* Custom wood options available upon approval.

\*\* Our reclaimed woods exhibit variations in tone and grain.

### METAL\*

#### STANDARD FINISH

White	<b>W</b> <b>H</b>
Slate Grey	<b>S</b> <b>G</b>
Matte Black	<b>M</b> <b>B</b>

#### PREMIUM I FINISH

Blackened	<b>B</b> <b>L</b>
Brushed Nickel	<b>B</b> <b>N</b>
Brushed Brass	<b>B</b> <b>B</b>

\* Custom options available upon approval.  
For polished metal, please inquire.

### COLOR TEMP

2400K	<b>2</b> <b>4</b> <b>0</b> <b>0</b>
2700K	<b>2</b> <b>7</b> <b>0</b> <b>0</b>
3000K (Standard)	<b>3</b> <b>0</b> <b>0</b> <b>0</b>
4000K	<b>4</b> <b>0</b> <b>0</b> <b>0</b>

### DRIVER & DIMMING OPTIONS\*

120V-277V (Universal dimming including 0-10V)	<b>U</b> <b>N</b> <b>I</b>
Remote Driver**	<b>R</b> <b>E</b> <b>M</b>

\* See dimming compatibility.

\*\* Direct-wall mounted option requires remote driver option.  
See remote driver specifications page.  
REM option includes driver and remote enclosure box.

### LIGHT OUTPUT

Standard Brightness - 12V (Dimmable)	<b>S</b> <b>B</b>
--------------------------------------	-------------------

### LIGHT DIRECTION

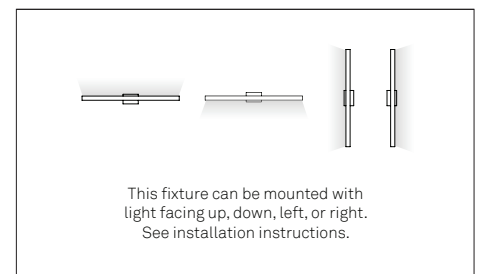

## UNI J-BOX MOUNTING FOR 2"x4" SWITCHBOX – BACK PLATE REQUIRED

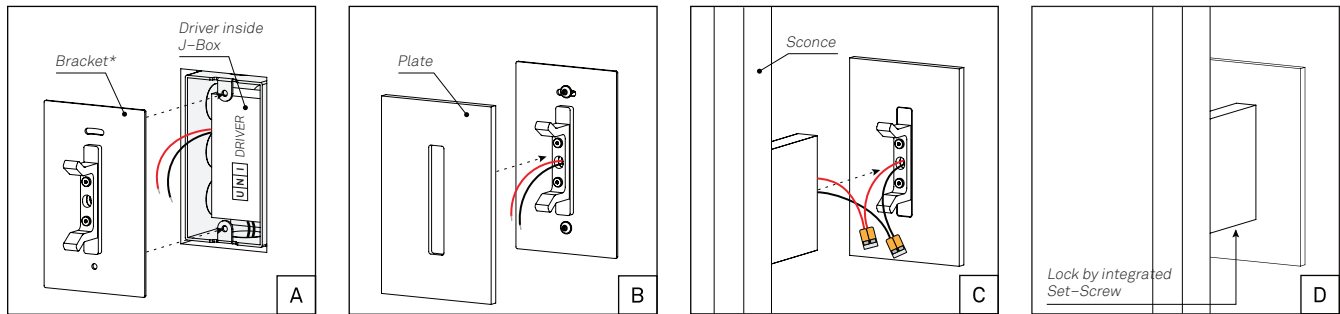

## UNI J-BOX MOUNTING FOR 4"x4" JUNCTION BOX – BACK PLATE REQUIRED

+ 2"x4" Switchbox Adapter (sold separately) must be installed before proceeding with steps A - D above

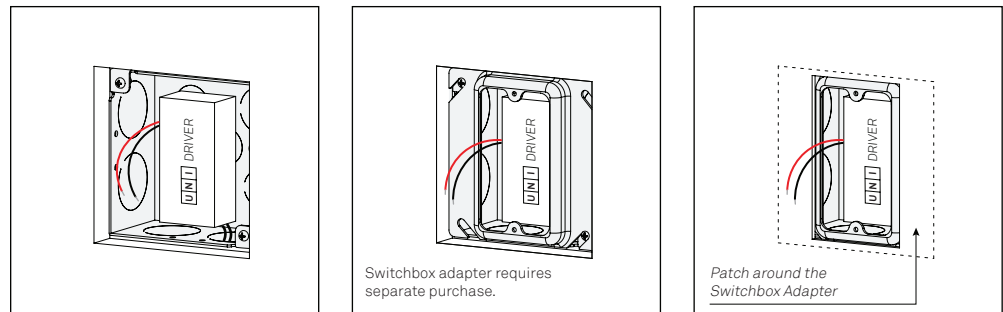

## REM DIRECT-WALL MOUNTING – NO BACK PLATE

+ Remote driver application only  
 + Requires blocking in wall  
 + Cleat mounts directly to wall  
 + Guideline Template provided  
 + Wire hole: Drill max  $\phi 1/4"$  to ensure hole is covered by cleat

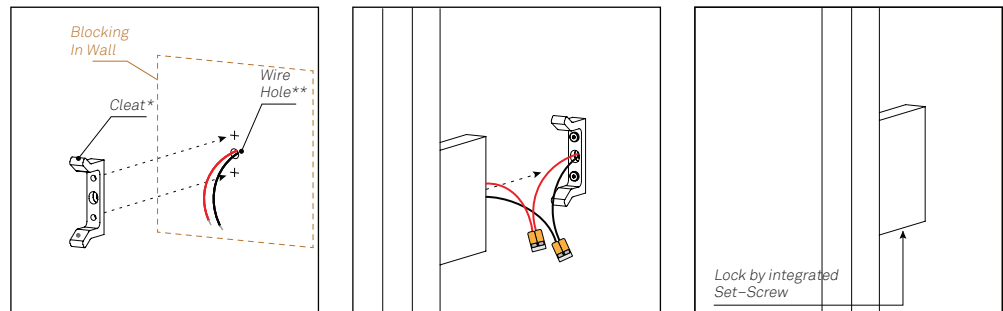

## REM DIRECT-WALL MOUNTING – WITH BACK PLATE

+ Remote driver application only  
 + Requires blocking in wall  
 + Bracket mounts directly to wall  
 + Guideline Template provided

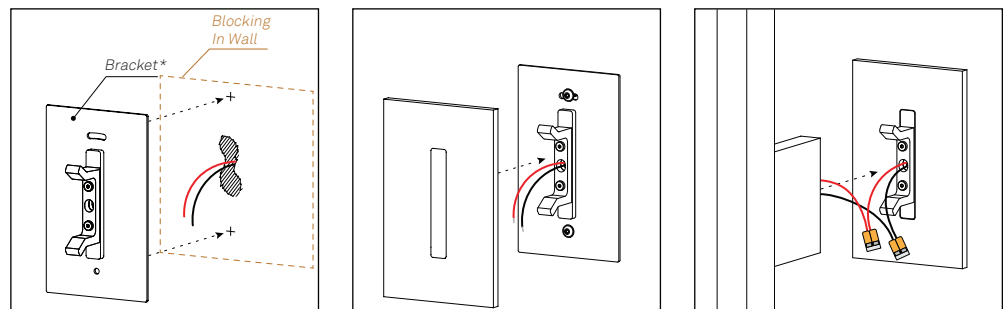

## CHOOSING WIRE GAUGE

Use the information below to determine the appropriate wire gauge to lead the driver to the sconces.

WIRE GAUGE	MAXIMUM LEAD LENGTH (10–20V)
24 AWG (0.2 mm <sup>2</sup> )	2.5ft (0.8m)
22 AWG (0.34 mm <sup>2</sup> )	4ft (1.2m)
20 AWG (0.5 mm <sup>2</sup> )	6ft (1.8m)
18 AWG (0.75 mm <sup>2</sup> )	10ft (3m)
16 AWG (1.5 mm <sup>2</sup> )	15ft (4.5m)
14 AWG (2.5 mm <sup>2</sup> )	25ft (7.5m)
12 AWG (4 mm <sup>2</sup> )	40ft (12m)

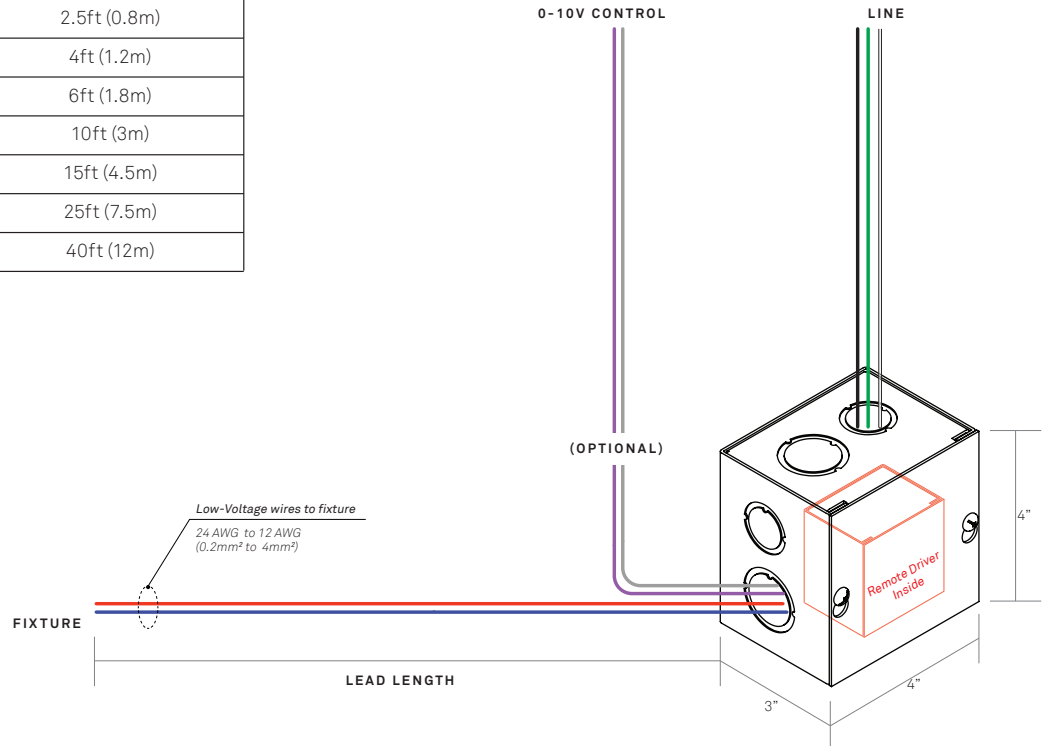

## MOUNTING DRIVER ENCLOSURE

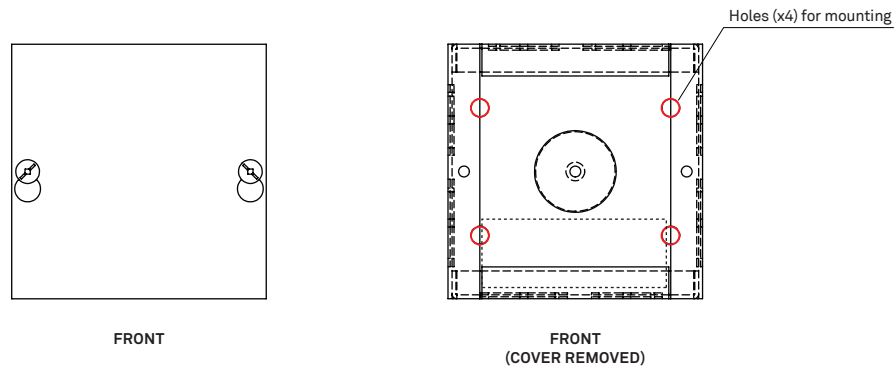

**120V-277V driver (Universal dimming including 0-10V)**

Manufacture's specifications (18" and 2' Ray Sconce):

[stickbulb.com/drivers/UNI6](http://stickbulb.com/drivers/UNI6)

Manufacture's specifications (3' Ray Sconce):

[stickbulb.com/drivers/UNI8](http://stickbulb.com/drivers/UNI8)

Manufacture's specifications (4' and 5' Ray Sconce):

[stickbulb.com/drivers/UNI12](http://stickbulb.com/drivers/UNI12)

**Low-Voltage Compatible Dimmer brands: Crestron, Lutron, Leviton**

For assistance selecting controls, contact LTF at +1 (847) 498-5832 or [LTFsales@LTFtechnology.com](mailto:LTFsales@LTFtechnology.com)

Brand	Part number	Brand	Part number	Brand	Part number
Crestron	CLS-C6	Lutron	DVCL-153P	Leviton	Model 6615
Crestron	CLS-C6M	Lutron	DVELV-303P	Leviton	Model 6672
Crestron	CLS-C6EX	Lutron	HQRD-6A	Leviton	Model 6674
Crestron	CLS-C6MEX	Lutron	HQRD-6NA-	Leviton	Model IPL06
Crestron	CLS-EXP-DIM	Lutron	NTELV-300-	Leviton	Model IPE04
Crestron	CLS-EXP-DIMU	Lutron	NTELV-600-	Leviton	Model IPI06
Crestron	CLX-2DIM8	Lutron	NVELV-600-	Leviton	Model VP106
Crestron	DIN-1DIM4	Lutron	VELV-600M	Leviton	Model VPE04
Crestron	DIN-1DIMU4	Lutron	MAELV-600-	Leviton	Model VPM06
Crestron	CLW-DIMEX-E	Lutron	MSCELV-600M	Leviton	Model VRE04
Crestron	CLW-DIMEX-P	Lutron	MIRELV-600-	Leviton	Model VRM10
Crestron	CLW-DIMSWEX-E	Lutron	MRF2-6ELV-120-		
Crestron	CLW-DIMSWEX-P	Lutron	SELV-300P		
Crestron	GLX-DIM6	Lutron	CTELV-303P		
Crestron	GLXX-2DIM8	Lutron	SELV-600-		
Crestron	P-DIMEX				
Crestron	CLW-DELVEX-E				
Crestron	CLW-DELVEX-P				



All of our wood and metal products should be dusted by hand with a dry Swiffer pad (or equivalent) on a regular schedule to maintain surface integrity. It is imperative that none of our products come into contact with bleach, vinegar, lemon juice or any household product which may contain these or other solvents.

If any part of one of our fixtures becomes soiled with dried residue or grime, wipe the affected area with a soft cloth dampened very lightly with warm water and immediately wipe dry with another soft cloth. If this does not complete the task, wipe with a cloth soaked in diluted mild liquid dish soap and again immediately dry.

Fingerprints on our Nickel-plated, Brass-plated, and Blackened metal hardware can be removed with a clean, dry, soft cloth. We recommend an ultra-fine, textureless microfiber cleaning cloth (as one uses to clean glass).

All of our Brass hardware is treated with a protective coating to prevent tarnish. It should need no more than a wipe with a clean, dry, soft cloth to remove fingerprints and dust.

Brushed metal surfaces should be buffed in the direction of the grain.

For scratches in wood we highly recommend Claphams beeswax, which is non-toxic and can be applied by hand. Rub a small amount into the scratch area and buff with a dry cloth.

